

RiverSpring Living Campus Map

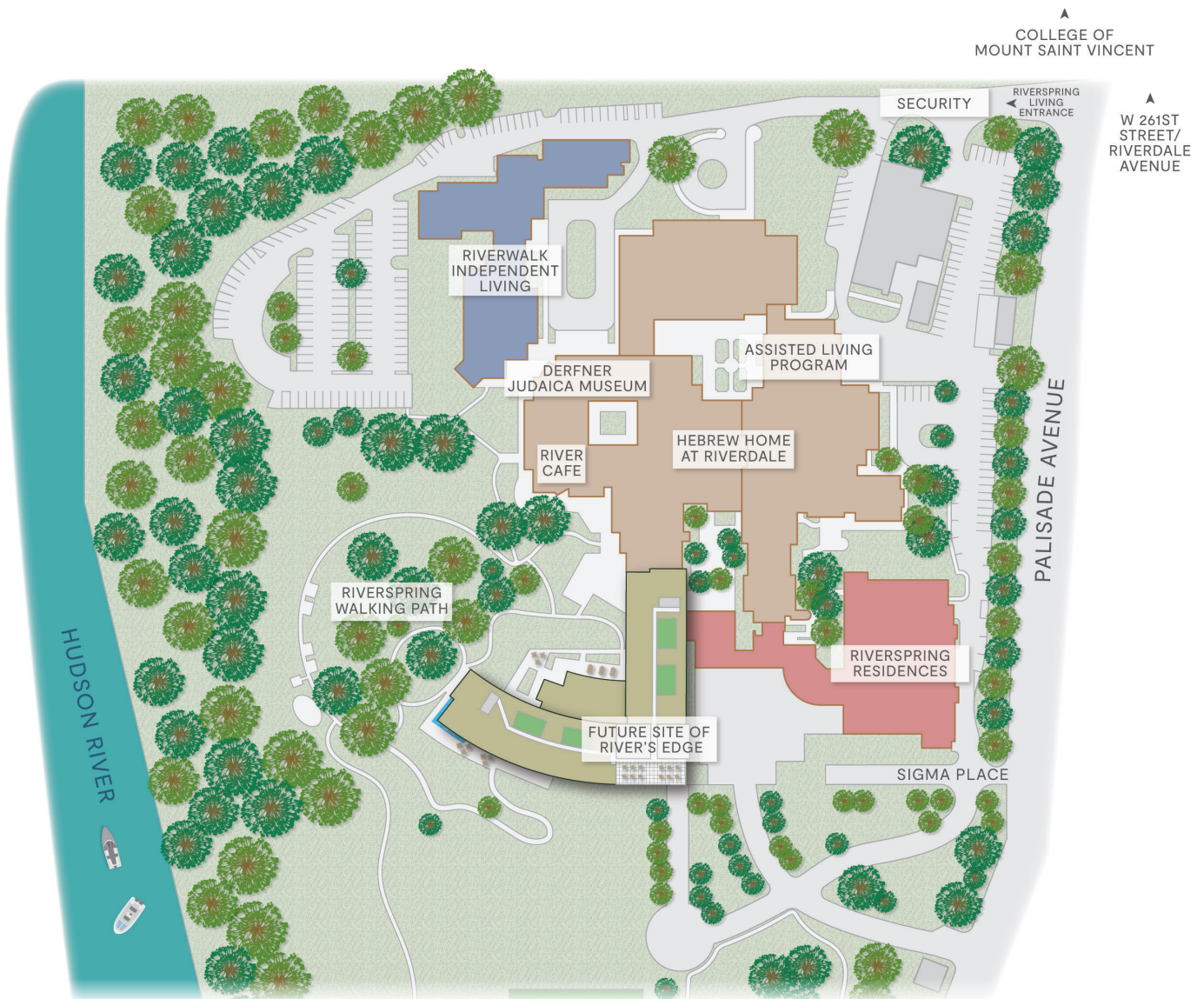

- RiverSpring Residences: RiverSpring Living's brand-new assisted living and memory care community.
- RiverWalk: RiverSpring Living's independent living apartment homes, featuring sweeping views of the Hudson.
- Future site of River's Edge: River's Edge will be the first and only Life Plan Community in New York City.
- Hebrew Home at Riverdale: RiverSpring Living's best-in-class, long-term care community.

📍 5901 Palisade Avenue, Riverdale, New York 10471

🌐 RiverSpringLiving.org ☎ (718) 581-1906

